



NOMAD

YACHTS



NOMAD 95



A heritage of boat building and a relentless pursuit for a joyful "Art de Vivre" have blended together to bring you the Nomad 95. A manifestation of luxury living at its finest, this vessel tempts you to relocate your main residence to one that has the best sea view.



Main Helm



Settee



Dining



Saloon



Owner's Stateroom



Owner's Seating Area



Owner's En Suite



VIP Stateroom



Main Galley



Twin Guest Stateroom



VIP En Suite



Walk-in Closet



Crew Cabin



Profile



Fly-bridge



Fly-bridge Helm

DECK PLANS

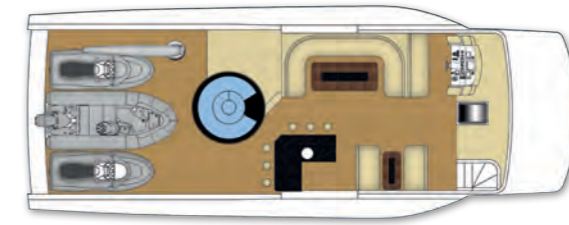

FLY-BRIDGE

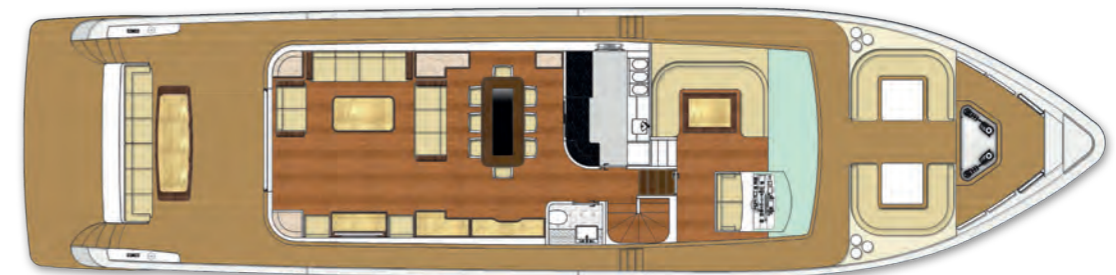

MAIN DECK

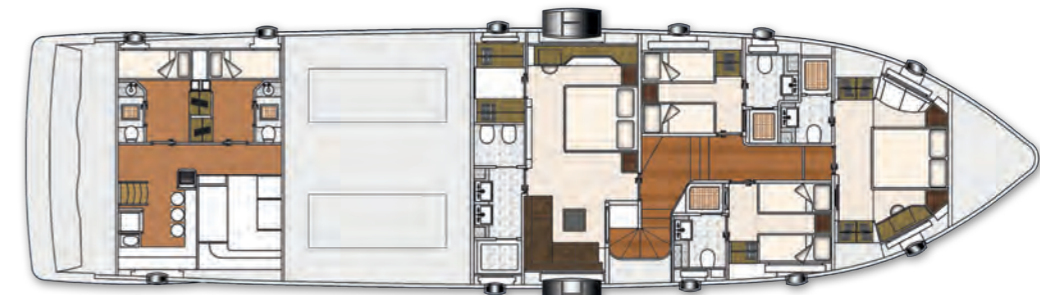

LOWER DECK

TECHNICAL SPECIFICATIONS

LENGTH OVERALL	: 98 ft 3 in (30.00 m)	ACCOMMODATION	: 4 Staterooms (8 Berths)
BEAM	: 23 ft 4 in (7.20 m)		: 2 Crew Cabins (4 Berths)
DRAFT	: 5 ft 3 in (1.60 m)	BATHROOMS	: 4 En Suite + 2 Crew + 1 Day Head
DISPLACEMENT	: 90 t Approx.	GENERATOR	: 2 x 40 kW, 50/60 Hz
FUEL CAPACITY	: 4,000 US gal (15,140 l)	POWER OPTIONS	: 2 x 1,920 hp
WATER CAPACITY	: 500 US gal (1,890 l)		: 2 x 1,200 hp
BLACK WATER CAPACITY	: 120 US gal (450 l)		
GREY WATER CAPACITY	: 120 US gal (450 l)		



Pictures in this catalogue may be taken from different vessels of the same type for example purpose only. Performance estimates are given in good faith, but are in no way guaranteed. Dirt on the hull, damage to the propellers, external water and air temperatures and added weight, fuel and water carried can all adversely affect performance. For these and other reasons we can give no performance guarantees. Data and characteristics are not binding, details, colors, descriptions and illustrations are for information purpose only. The drawings and pictures may include specific equipment or modifications which are not part of the standard specifications of the vessel, standard specifications may be defined differently in different sales territories. Gulf Craft Inc. reserves the right to make any changes in specifications or equipment without prior notice. In case of any inconsistencies between specification sheet, product catalogue and price list, the price list prevails. Customers are recommended to contact our sales representative to reconfirm standard and optional features on the vessels.



by *Gulf Craft*

PO Box 666, Ajman, UAE | T. +971 6 7406060 | F. +971 6 7406062

www.gulfcraftinc.com | gci@gulfcraftinc.com

Y17.V7